

moreborn

Kitchen Waste Composter

MB12m

Instruction Manual



► INTRODUCTION PAGE

From dining tables to gardens,
it is a new life style of focusing on the environment

Intelligent Composter Capable of Utilizing Food Waste

Food waste is very annoying that smells bad, attracts flies, and makes kitchen messy. Moreover, the landfill of food waste causes rotting that will pollute the air, the penetrating fluid to be produced will pollute the groundwater, and the methane to be produced will bring a serious greenhouse effect, all of which have a negative impact on the environment.

Fortunately, the nature gives us an inspiration of disposing the food waste — composting. Food waste will be slowly decomposed and turned into fertilizer under the natural conditions.

We combine this natural phenomenon with modern technology, collect the microorganism samples from the natural world and place them in the substrate (their home). We put them into the product, and the technology contained in product can always keep the optimal environmental conditions for the survival of microorganisms e.g. temperature and humidity etc., and assist in grinding food waste into fragments to increase the contact area with microorganisms. The process of decomposing food waste and composting can be completed in a high-quality manner in a short period of time (48 hours +). This not only makes compost quick and easy, but also reduces the carbon footprint created by burying food waste.

Turn waste into energy and give back to our planet, make a contribution to the environment where we live together.

Manual

Contents

I. Safety Precautions	1
II. Component Name and Instruction	3
III. Installation and Preparation for Use	5
1. Installation	
2. Preparation for Use	
IV. Types of Food Waste Available to Putting in	7
V. Use Instruction	8
1. Control and Display Instruction	
2. Daily Use	
3. Fetch Fertilizer	
VI. Microorganism and By-product Management	11
1. Microorganism and By-product	
2. How to Grow with By-products	
VII. Cleaning and Part Replacement	12
1. When the by-products need to be cleaned	
2. How to clean filter screen	
3. How to change odor filter	
4. Other Aspects of Cleaning	
VIII. Frequently Asked Questions	14
IX. Troubleshooting	18
IX. Warranty and Maintenance	19

I . Safety Precaution

! Important Safety Instruction

WARNING: Your safety is important to us. In order to reduce the risks of fire, electric shock, etc. when using this product, please read carefully and follow the basic safety precautions before use. Failure to comply with the following items may lead to the above-mentioned safety accidents. For your safety and that of others, please strictly abide by.

It is not recommended for the people with reduced physical or sensory capabilities, mental abilities, or common sense, including children to use this device, unless they are able to use under the supervision of an adult who understands the product and takes responsibility for their safety.

Children should be supervised to ensure they don't play with the product.

In case of any damage to the power supply cord, which should be replaced by the manufacturer, its service agent or a similarly qualified person approved in order to avoid any hazard.

⊗ Prohibited categories

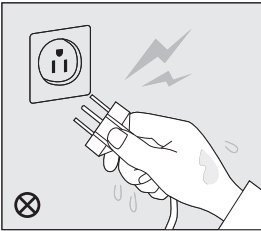

It is strictly prohibited to touch and operate the power plug and socket with wet hands. (It may cause electric shock)

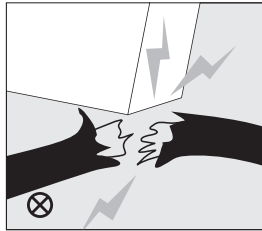

Ensure the power cable not to be held down by heavy objects, and keep away from sharp objects. (Accidents that may cause electric shock or fire)

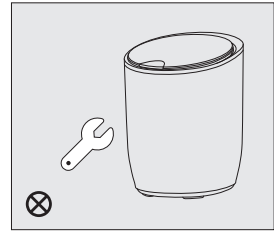

No one other than an official or authorized technician may disassemble, repair, or change the product without permission. (There is a risk of injury, fire, or electric shock)

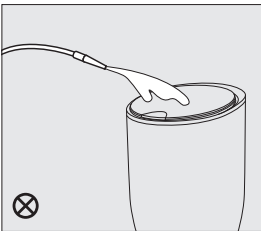

Do not flush or wash the product directly with water when cleaning, and avoid putting the product in places where water may leak. (Cause of electric shock or failure)

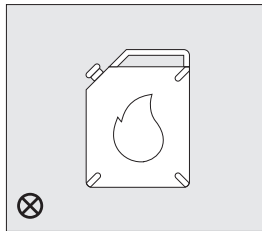

Avoid using flammable substances such as gasoline and natural water when cleaning. (It may cause explosion, fire, etc.)

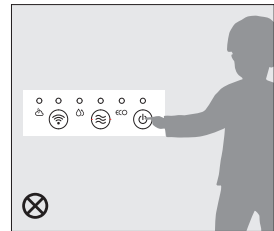

Please do not let the elderly or children install or operate the machine. (It may cause risk of injury)

I . Safety Precaution

⊗ Prohibited categories



Please do not let children eat or touch microorganisms. (It may cause illness or injury)

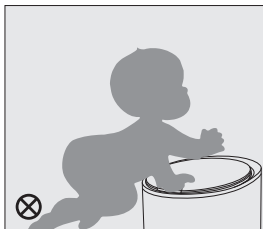

Please do not let children climb or do it on the product (It may cause serious trauma)



Please do not manually force the mixing shaft or cutter head (It may cause hand injury and product failure)

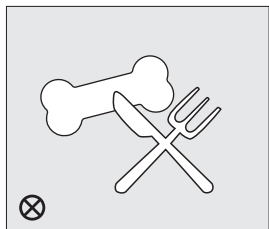

Please do not manually force the mixing shaft or cutter head (It may cause hand injury and product failure)

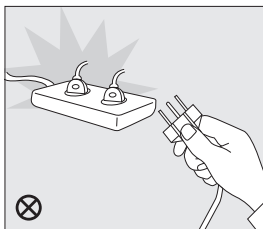

Avoid connecting multiple electrical devices to one plug-in board at the same time. (It may cause overheating, overload, and fire)

❗ Attention category

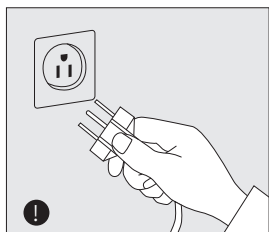

When using the power plug, you should use the correct grasping position to prevent electric shock

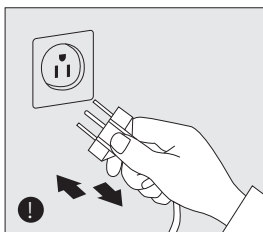

Since the voltage is different in each country, please check whether the voltage matches the shape of the plug when using

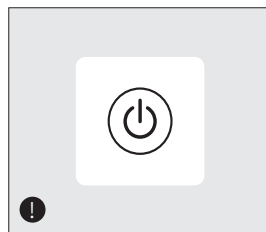

Please keep the power on at all times, and the product has an automatic energy saving mode (Turning off will cause poor living conditions for bacteria, and a large number of deaths)

II . Component Name and Instruction

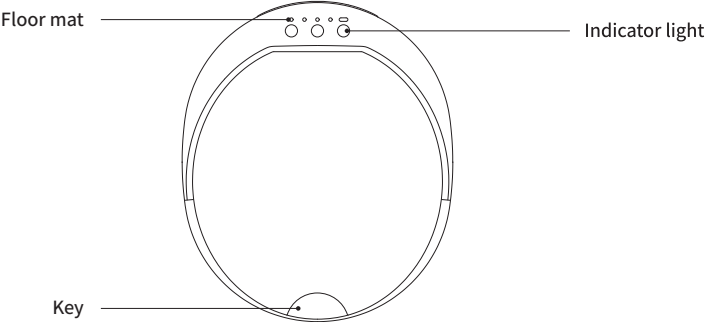
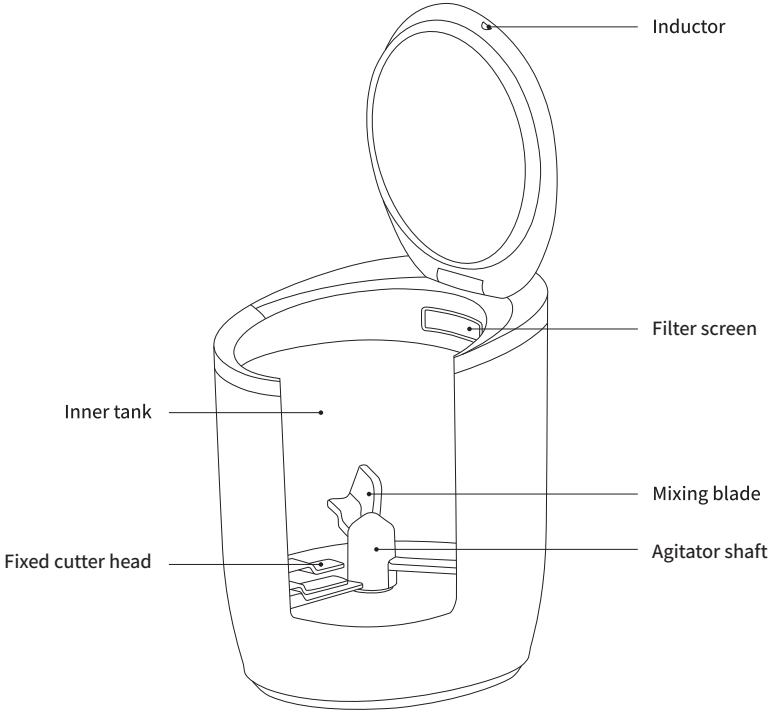

II . Component Name and Instruction

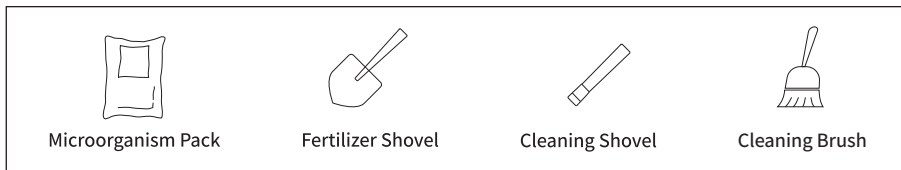
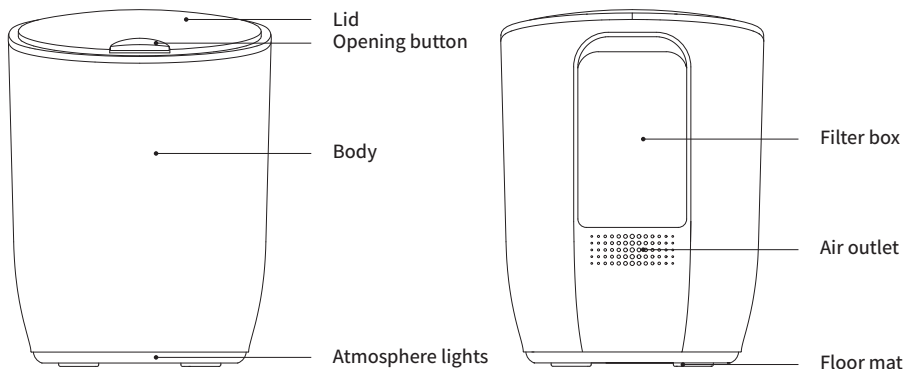

Product Specifications

Maximum power: 200w

Voltage: 140 ~ 240V

Rated frequency: 50~60Hz

Maximum volume: 12L

Maximum daily processing capacity: 1.5 kg

Working temperature: 37-55°C

Working humidity: >55rh%

Working noise: ≤45dB

Product size: 300 × 360 × 420mm

Product weight: 10kg

III. Installation and Preparation for Use



Please avoid letting the elderly, the infirm and children unpack the product or install the product.

1. Installation

1

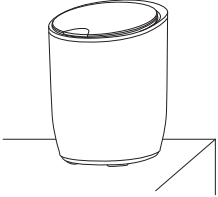

Please place the product in a well-ventilated area, either on the table or on the floor (E.g. kitchen countertops, indoor garden/balcony, etc.).

2

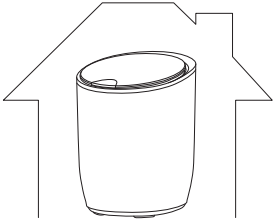

This product is only applicable to the indoor use. Please do not place the product in an outdoor environment or an enclosed space. (Such as outdoor garden/lawn, bathroom or bedroom, etc.).

3

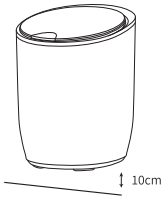

If the floor where it is placed will inevitably be wet, please use a shelf to ensure that the product is at least 10 cm from the ground. (Avoid the risk of electric shock that may be caused by contact with water)

4



Please place the product on a level surface to use. (Vibration, noise, and airflow disturbances may cause bad odors or fault)

5

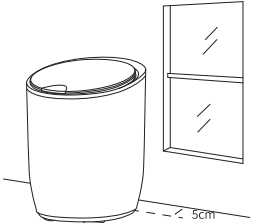

Please leave a gap of at least 5 cm between the product and rear wall. (Easy discharge of purified gas)

III. Installation and Preparation for Use

2. Preparation for Use

1

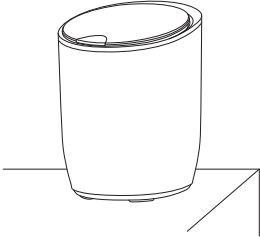

Take the product out of the package and place it on a flat surface near the power supply

2

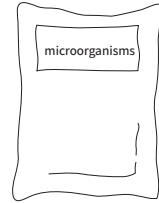

Take out the microorganism pack

3

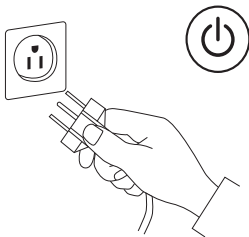

Connect to the power supply, and ensure the product has been powered on. Please don't start working first

4

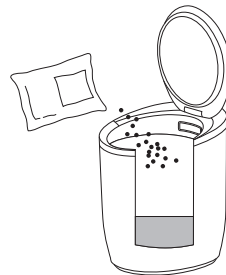

Pour the whole pack of microorganisms into the product liner and spread evenly

5

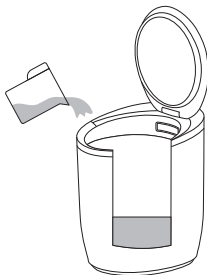

Pour in about 800ml clean water, and close the lid for running at least 20 hours to activate microorganisms

6













You can put in the food waste after 20 hours for use

IV. Types of Food Waste Available to Putting in





Microorganisms can decompose most of the food waste, but there are still a few hard bones that cannot be disposed of. From the perspective of decomposing garbage and composting, please put in the compostable food waste by following the instructions below.

✓
type of food waste

			
Fruits and vegetables	Pit peel	Rice noodles	Pastry bread
			
Poultry eggs	Meat food	Leftovers	Coffee tea grounds
			
Fish bone shrimp shell	Napkins	Small chicken bones	

The pits do not contain abnormally hard types such as durian peel and peach kernels

✗
Types of non-compostable food waste

			
Shellfish	Bones such as pork, beef, sheep, etc	Cutlery	Cigarettes and medicines



Putting in the types of non-compostable food waste will cause an impact on product performance and microbial activity. Please follow the requirements and screen out these wastes without putting them into the product.

V . Use Instruction

1.Control and Display Instruction

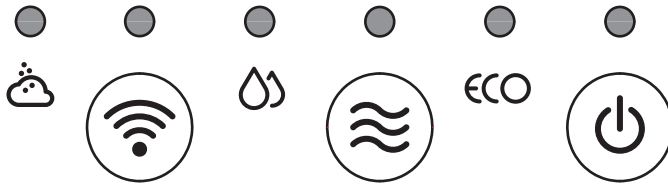

Power button:

After plugging in, short press to turn on, long press to turn off, and the breathing light above the button flashes when the cover is opened, indicating a pause;



Deodorizing button:

After clicking, it will quickly filter out the internal gas, reduce the internal smell, and make the experience of opening the lid and throwing away food waste better;



Network button:

Touch gently to activate the network, please download app in advance and connect to the Internet according to the instructions



Fatty retrievable display:

Automatic logic and inoperable. When the decomposition and composting of internal kitchen waste is completed, this lamp lights up to indicate that the by-products can be taken out for planting;



Automatic dehumidification display:

Automatic logic and inoperable. When the internal humidity, temperature and fan meet the corresponding judgment conditions, automatic dehumidification is turned on, and the display light is on at the same time;



Energy saving mode display: Automatic logic and inoperable. Power consumption is reduced under this mode, up to 0.3 kwh at minimum.

V . Use Instruction

2.Daily Use

①After the product is installed, make sure the power is turned on and the product is running.

②Gently press the button to pop open the lid and put food waste inside.

❗ The product will stop automatically after opening the lid. This is a normal setting to ensure safety when putting food waste

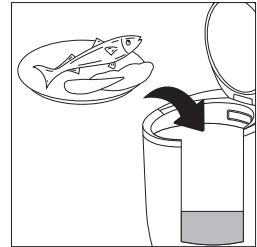
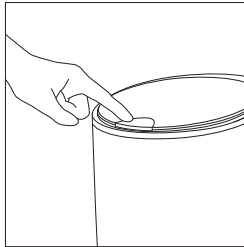
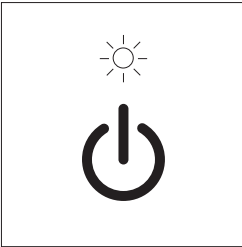

❗ Precautions when feeding food waste:

①It is recommended to put in no more than 1.5 kg of food waste per day, otherwise it will affect the efficiency of composting because it is too humid;

②As for the food waste with much cooking liquor, please put in upon draining the cooking liquid;

③If the purpose of putting in food waste after putting it in is to compost rather than simply dispose of garbage, clean and rinse dishes with high salt content (such as kimchi and bacon)



<1.5kg/day

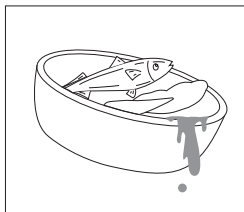

Reduce cooking liquid

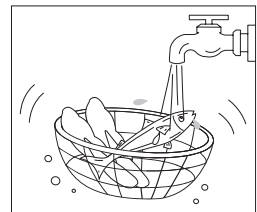

Rinse the food waste

V . Use Instruction

3. Fetch Fertilizer

①If you want to fetch fertilizer, please stop putting in food waste 48 hours before fetching to ensure sufficient time for internal food waste to decompose and ferment.

②The green light of completing the composting is on, proving that the internal food waste has basically been decomposed and fermented. You can open the lid to fetch fertilizer now.

Note: When fetching fertilizer, please do not lower the microorganisms retained in the interior below the minimum scale line.

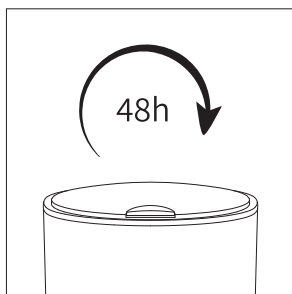

at least 48 hours without input

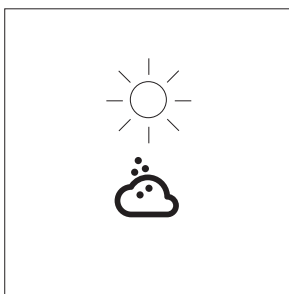

The compost light on (green)

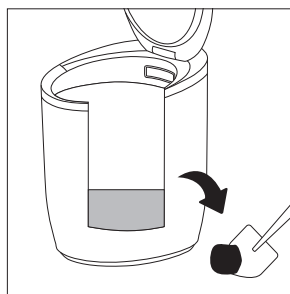

Take out the compost

VI. Microorganism and By-product Management

1. Microorganism and By-product

The microorganism pack consists of microorganisms that can decompose food waste and a substrate. As a carrier for microorganisms, the substrate can provide an environment for microorganisms to attach and live, which look like the wood chips.

After you use it normally, they will slowly turn into a dark brown powder. This is because after putting in food waste and microorganisms break it down, the organic matter, nitrogen, phosphorus, potassium will be produced with some lignin and cellulose. These brown powdery products can return to nature and be used by other organisms. We call these brown powders “by-products.”

These by-products can be used as the supplementary planting/composting, or as general waste/dry waste disposal.

2. How to Grow with By-products

First and most importantly, we recommend not putting in food waste for at least 48 hours before using the by-products to ensure that the food waste within the by-products is fully decomposed and decayed (the longer this time, the better).

When planting crops or plants, the by-products should not be used alone just as you can't plant with fertilizer directly. They should be mixed with soil, and the best mixing ratio is by-products: soil = 1: 6.

If apply fertilize only for the indoor pots, about 10-15g by-products are needed. Please bury them away from the roots with 2-3cm soil covered on top.

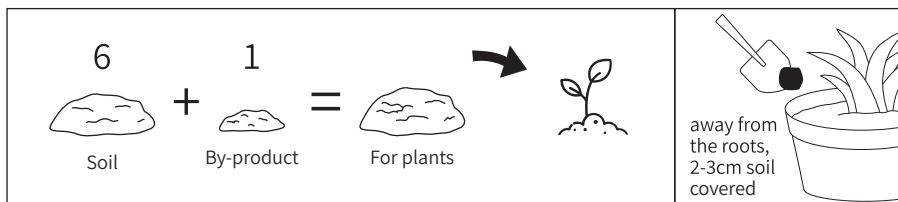

❗ Why are there the white molds sometimes?

Filamentous white molds are called white actinomycetes. They can break down lignin and cellulose that are not easily broken down. They tend to occur when the humidity is too high. This also often happens during natural composting, which is a normal phenomenon. Whether it appears in the product barrel or in the flower pot, please stir these actinomycetes to mix with the by-products and soil. It is also able to improve this phenomenon by reducing the amount of kitchen waste or reducing the frequency of watering .

VII. Cleaning and Part Replacement



For safety, please be sure to unplug the power plug when cleaning the product

1. When the by-products need to be cleaned

More by-products will be produced after using for a period of time. Please clean the by-products if exceeding the maximum scale line. You can open the lid and scoop out the internal by-products with a shovel. Please ensure that the remained by-products inside not lower than the minimum scale line so as to preserve sufficient microbial growth and decompose the food waste to be put in the future.

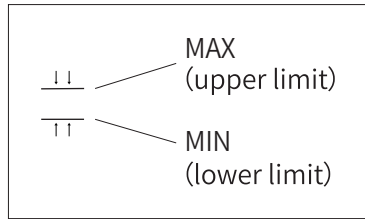

2. How to clean filter screen

When there is a layer of brown dust on the filter screen, the filter screen should be disassembled and cleaned. First, disassemble the filter screen according to diagram, clean with a brush under the flowing water prior to drying and putting it back.

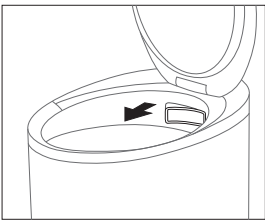

Outward disassembly

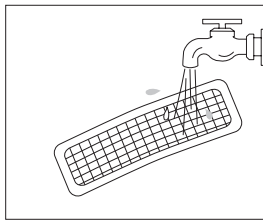

Clean

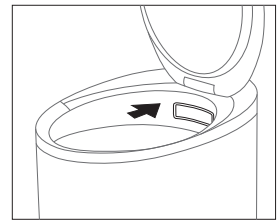

Put it back

VII. Cleaning and Part Replacement

3.How to change odor filter

It is recommended to replace the activated carbon pack in the odor filter once every 6 months (The specific time depends on the usage. If you smell an obvious sour smell when closing the lid, which indicates that the activated carbon bag needs to be replaced)

Please pull the filter box outwards when replacing. Disassemble the box according to diagram, replace the activated carbon bag, close the lid again, insert the box into the slot, and push it firmly into place.

- ❗ The outer of carbon bag is made by non-woven filter cotton that can absorb dust and moisture. There is no need to cut when replacing but replacing with the whole pack. The used carbon pack materials can be decomposed and disposed of as general garbage.

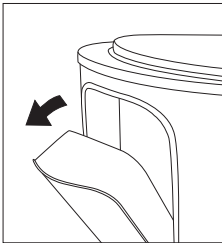

Pull the filter box

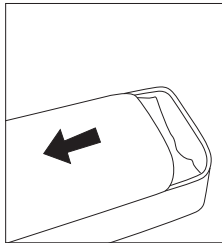

Open the lid

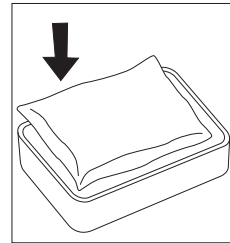

Change the activated carbon package

Please contact the official website or other authorized channels to purchase activated carbon packs for deodorization
Official Website: www.moreborn.net

4.Other Aspects of Cleaning

When the microorganisms dry on the barrel wall, mixing shaft or fixed blade, please disconnect the power first, and remove the dried microorganisms with a cleaning shovel to mix with the whole pack of bacteria. They will be mixed together naturally after starting normally, and the dried microorganisms will be reactivated.

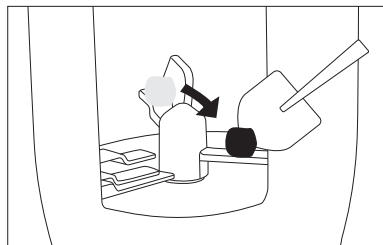

VIII. Frequently Asked Questions

Q: There is condensate on the inner surface or inner wall of lid.

A: The internal temperature of product will maintain in two main ranges 37 and 55°C, which is suitable for microorganisms to decompose food waste and culture. This will cause a temperature difference between inside and outside. When the moisture of garbage to be put in is increased, the condensate water will be produced. It is a natural phenomenon instead of a product problem.

The product has an automatic dehumidification function. When the automatic dehumidification lamp is on, which indicates the dehumidification is ongoing. The automatic dehumidification lamp will turn off after completion, and the situation will improve now.

Q: Why does the product stop working once I open the lid?

A: This is a setting for safety. The product can only work when the lid is closed, and it will automatically stop after opening.

Q: You can smell a sour smell of decomposing the kitchen waste inside once opening the lid.

A: Microorganism can produce the volatile gases e.g. acetic acid etc. when decomposing most kitchen wastes, and there is a sour smell (the actual smell depends on the type of food you put in).

You can put in the kitchen waste e.g. citrus fruits (such as oranges) or coffee grounds to neutralize this sour smell.

You can also click the deodorizing button before opening the lid, making the internal sour smell quickly filter and discharge. Open the lid after 5 minutes. It is also able to effectively reduce this sour smell.

VIII. Frequently Asked Questions

Q: Can I put in frozen food?

A: The low temperature of frozen food causes microorganisms to enter a dormant state, which reduces their ability of decomposing food. Although there is a temperature maintenance inside and it doesn't have a significant effect, it is still recommended that the frozen food should be put in after unfreezing to the normal temperature.

Q: The microorganisms inside look very sticky.

A: The over stickiness indicates a high moisture due to the food waste contains a lot of water. Putting in too much food waste and frequently will make the internal microorganisms look sticky.

Please suspend putting in food for 2-3 days until the internal microorganisms are in an appropriate state.

Q: The microorganisms inside look very dry.

A: The inner chamber of product will automatically adjust the temperature rise according to the humidity after putting in the waste. Even if not putting in the garbage, it will maintain at around 37°C to ensure a comfortable living environment for microorganisms. Thus if not putting in the food waste for a long time, this temperature will also slowly make the interior dry slowly with more dust (It may cause a block to filter screen).

The simple solution is to continuously put in waste, or pour about 800ml clean water, close the lid to make it return to the normal humidity again. If there is brown dust on the filter screen, please clean it prior to performing the above-mentioned operations.

VIII. Frequently Asked Questions

Q: Microorganisms will aggregate and stick to the inner wall or mixing shaft.

A: We design the mixing shaft in the center and make it stir the mixing of microorganisms and food waste as much as possible. There are certainly some remainings that are not mixed on the inner wall and mixing shaft. These few dry microorganisms will lie dormant on the inner wall and mixing shaft without affecting the use. You can also remove them with a cleaning shovel and mix with the internal by-products so as to re-activate them.

Q: If not putting in food, will the microorganisms die?

A: No. The microorganisms we use will turn into spore form and hibernate in the absence of food, then transform back into microorganisms and continue to decompose upon putting in food again.

Q: Do I need to buy and refill microorganisms frequently?

A: No need. Microorganisms use nutrients from food waste to synthesize themselves and reproduce. You only need to ensure that the total amount of microorganisms inside the product is always above the minimum scale.

Of course, there may circumstance that salinity reduces the microbial activity due to various uncontrollable factors of food waste to be put in. Therefore, it is recommended to supplement the microorganisms once every 1 year.

Q: If I take a business trip or travel outside for continuously several days, do I need to take measures against products or microorganisms?

A: If your departure duration is less than one week, you don't need to take any extra measures, and the product will automatically enter the energy saving mode.

If your departure duration is more than one week, it's recommended to stop putting in food at least 48 hours before departure to ensure the remaining food waste can be completely decomposed. Please disconnect the power supply on the day of departure.

VIII. Frequently Asked Questions

Q: There are white molds growing on the inner wall and microorganisms.

A: These white molds are actinomycetes that can also exist on surfaces during normal composting. They help decompose the lignin and cellulose, and appear if not mixing for a long time (such as the upper side of barrel wall where the mixing shaft cannot reach, return after a power outage due to travelling or business trip, etc.) Please remove these white actinomycetes with a shovel and mix them with microorganisms, the molds will disappear after a few hours.

*If there are a large amount of molds that can't be removed by the above method, it may be due to a product abnormality, please contact the official after-sales service for resolving.

Q: If app displays the product is off line, does it affect the product usage?

A: Even if the product is off line, it will not affect the normal use of product. Because the temperature and humidity control algorithm and other programs have been embedded in the product, it can decompose food waste and compost regardless of on line or off line.

Off-line will only affect the function of mobile app.

IX. Troubleshooting

Phenomenon	Reasons	Solution
Power supply's red light is flashing.	Mixing shaft is blocked	<p>Please disconnect the power first.</p> <p>Open the lid to check if hard waste such as pork bones and shells has been put in. If there are any, clean them up.</p> <p>Open the lid to check if putting into the hard garbage such as pork bones or shells etc. If so, clean them up.</p> <p>Connect power for normal operation</p>
Automatic dehumidification red light is flashing	Reading value of humidity sensor is abnormal	<p>The filter screen may be blocked, please disconnect the power first;</p> <p>Remove the filter screen inside barrel, clean it with a brush and clean water</p> <p>Install back after cleaning and start the machine.</p>

! Please seek an officially designated person to perform the door-to-door repair. We are not responsible for any accident caused by unofficially approved, designated personnel repairing or modifying product.

X . Warranty and Maintenance

The warranty period of the whole product is one year (calculated from the date of purchase).

moreborn



Company Name:

Hangzhou ATC Ecological Technology Co., Ltd;

Company Address:

Room 1103, Building 2, Xinyuan Jinzuo, Nanyuan Street,
Linping District, Hangzhou City, Zhejiang Province;

Official Website:

www.moreborn.net